

Has Supply and Exhaust Valves



Has Supply and Exhaust Valves

Plastic Supply/Extract Air Valves (PAV)

Having the benefit of being used in supply or extract applications HAS polypropylene air valves are suitable for wall, ceiling or exposed duct mounting. A central disc is attached to a thread rod making the valve infinitely adjustable and locking nut ensures settings are securely maintained.

Fixing: As standard a mounting ring is supplied with each valve. The mounting ring should be securely fixed into the duct before the valve is pushed into the ring.

Construction: Both the valve and the mounting rings are manufactured from a durable white polypropylene material. This offers the benefit of being anti-static and corrosion resistant making them ideal for use in humid environments.

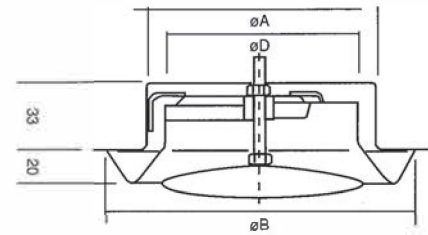

Duct Dia	A	B	D
100	100	150	80
125	125	170	100
150	150	190	120
200	200	240	170

Steel Supply Air Valves (MSV / MEV)

Designed to keep cost levels to a minimum whilst offering a robust and attractive appearance HAS steel supply/extract valves are ideal for virtually any application. Simple regulation of the airflow is achieved by rotating the inner cone to the correct setting and locking into place with a single nut. For cleaning purposes the unit can be easily removed, cleaned and replaced without affecting the adjustment of the valve.

Fixing: The mounting ring should be secured in position, the valve can then be fixed by a 'screw' action to locate the valve lugs into grooves in the mounting ring itself.

Construction: The HAS supply valve is manufactured from a high quality sheet steel, stove enamelled in white. To help prevent air leakage the valve body has a cellular plastic gasket to form an airtight seal with the mounting ring. Every valve is supplied with a galvanised mounting ring and a measuring data sheet to facilitate accurate adjustment.

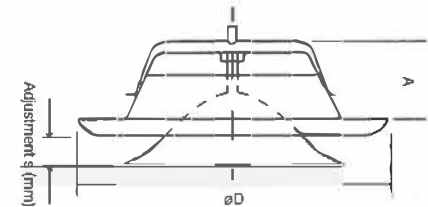

Duct Dia	øD	A	Weight g
80	115	41	140
10	137	47	190
12	5164	49	310
150	202	51	350
160	212	60	500
200	248	75	730

Fire Valve

KSOF is developed for use as a fire damper valve in exhaust ventilation systems.

Fire damper valve KSOF is CE marked based on product standard EN 15650:2010 and tested according to test standard EN 1366-2.

- CleanVent coating as standard
- Manufactured of sheet steel
- Horizontal and vertical ducting
- CE marking SP 0402-CPR-SC0768-13
- Fire class according to EN 13501-3
- Installation into gypsum board wall: E 45 (ve i <-> o) S or E 60 (ve i <-> o)
- Installation into rigid wall and floor: E 60 (ve i <-> o) S or E 120 (ve i <-> o) S or E 120 (ho i <-> o)

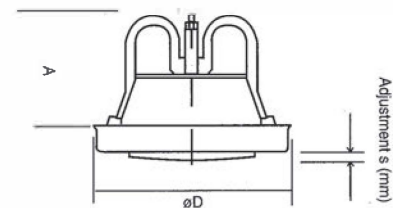

Duct Dia	øD	A	Weight g
100	134	74	280
125	160	85	360
150	191	89	470
160	191	89	470
200	241	107	720

Head Office Heath Mill Road, Wombourne, Wolverhampton, West Midlands WV5 8AP

Head Office 01902 895161
Wolverhampton Branch 01902 895161
Hailsham Branch 01323 847910

London Branch 020 8803 9622
Rochester Branch 01634 672730
Stoke Branch 01782 274000

Bury Branch 0161 796 8226
Nottingham Branch 0115 979 4527
Eastleigh Branch 02380 612954

sales-vent.co.uk www.has-vent.co.uk